

WB486SB AL V爆炸图 48SB060004B

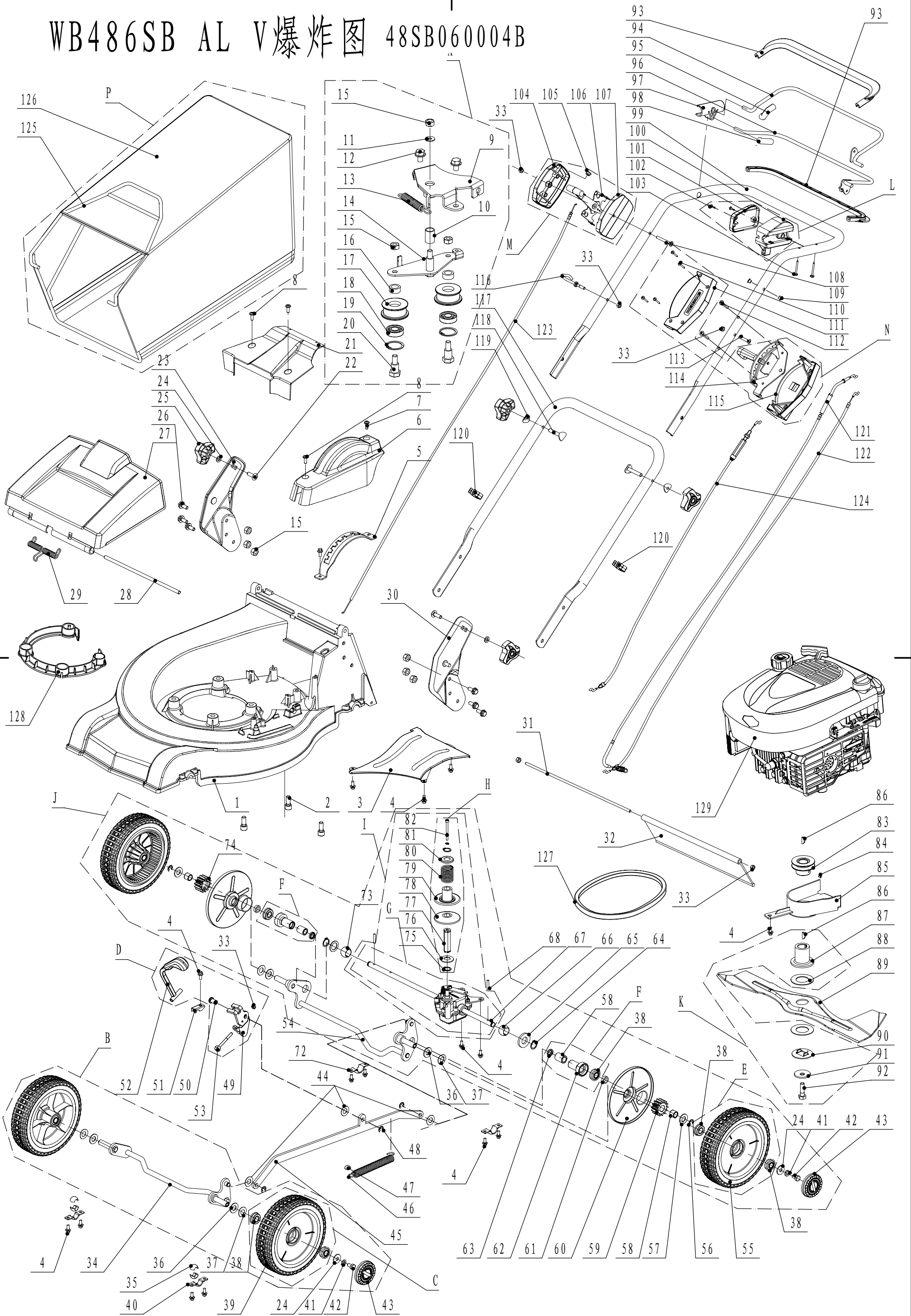

WB486SB AL V Ersatzteilliste

Order	Teil Nummer	Bez.: Deutsch	Bez.: Englisch	Anzahl
1	4820101001	Gehäuse	mower chassis	1
2	4820102010	Schraube	inner hexagon screw	3
3	4820103010	Schutz	bottom deflector for discharge chute	1
4	4820104010	Schraube	hexagon flange lock screw	16
5	4820105010	Höhenverstellung	height adjustment graduator	1
6	4820107010	Schild	height adjustment shield	1
7	4820106010	Schraube	inner hexagon lock screw	1
8	4820122010	Schraube	inner hexagon lock screw	3
9	4820109010	Armklammer	tensional arm bracket weldment	1
10	4820112010	Nylon Klammer	nylon bush for tensional arm bracket	1
11	0302008000	Scheibe	big spacer	1
12	4820113010	Bolzen	hexagon flange lock bolt	2
13	4820114010	Feder	spring for tensional arm	1
14	4820115010	Spannarm	tensional arm weldment	1
15	0202008000	Mutter	hexagon flange lock nut	9
16	4820118010	Buchse	bush for tensional pulley	2
17	4820119010	Spannrad	tensional pulley	2
18	6001-2RZ	Lager	bearing	2
19	0901028000	Ring	inner check ring	2
20	4820120010	Spannbolzen	tensional pulley bolt	2
21	4820121010	Schild	upper belt shield	1
22	4510513010	Bolzen	square neck bolt	2
23	4820125010	rechter Halter	right bracket assembly	1
24	0301008000	Scheibe	flat washer	6
25	4820541010	Knopf	knob	4
26	0102008016	Bolzen	hexagon flange bolt	6
27	4820126010	Abdeckung	rear cover	1
28	4820127010	Stange	rear cover pivot	1
29	4820128010	Feder	rear cover torsional spring	1
30	4820123010	linker Halter	left bracket assembly	1
31	5020117010	Stange	rear axis	1
32	4510111030	Schutz	rear deflector	1
33	0202006000	Mutter	hexagon lock nut	5
34	4820201010	Frontachse	front bearing bracket	1
35	5310209010	Lager	bearing	4
36	5310210010	Scheibe	spacer	4
37	5310211010	Feder	equalizing spring	4
38	5310213010	Lager	WB bearing	10

39	4820209010	Vorderrad 8"	8" front wheel	2
40	4820208010	Lagerhalterung	front bearing bracket	2
41	0401008000	Federscheibe	standard spring washer	4
42	0101008015	Bolzen	hexagon bolt	4
43	4520205010	Radschild	wheel hub cover	4
44	4820306013	Nylonscheibe	nylon washer	3
45	4820306010	Stange	draw staff weldment	1
46	4820307010	Feder	draw staff spring	1
47	4820307011	Sicherungskappe	D type check cap	1
48	1301008000	Sicherungsring	check ring	3
49	4820310010	Höhenverstellarm	height adjustment arm weldment	1
50	4820309010	Stift	draw staff pin	1
51	4820308010	Klammer für Höhenverst.	height adjustment arm clamp	1
52	4820313010	Höhenverstellgriff	height adjustment handle assembly	1
53	0101006065	Bolzen	bolt	1
54	4820301010	Hinterachse	rear axis weldment	1
55	4820305010	Antriebsrad	8"propelled wheel	2
56	1301009000	Sicherungsring	check ring	2
57	5020311010	Reibscheibe	friction spacer	2
58	5320326010	Lager	bearing	4
59	5320320010	Zahnrad links	left output gear	1
60	4520308010	Radabdeckung	rear wheel dustproof cover	2
61	4820318010	Buchse	main axis bush	2
62	5320324020	Lager	left bearing bush	2
63	5320327010	Staubabdeckung	dustproof ring	2
64	1001020000	Sicherungsring	A type check ring for shaft	2
65	4820326010	Scheibe	left spacer of bearing bracket	1
66	5320328010	NylonLager	nylon bearing	2
67	4820315011	Getriebe	gearbox	1
68	5320322010	Stift	slide pin	2
69	4820319010	Getriebeanschlag	gearbox bracket	1
72	5320114020	Lagerhalterung	bearing braket	2
73	4820327010	Scheibe	right spacer of bearing bracket	1
74	5320321010	Zahnrad rechts	right output pinion	1
H	4820320000		speed variator assembly	1
75	1001017000	Sicherungsring	outside check ring	2
76	4820320010	Scheibe	inner hexagon spacer	1
77	4820321010	Adapter	inner hexagon adapter	1
78	4820322010	Radscheibe	low disk of pulley	1
79	4820323010	Radscheibe	active disk of pulley	1
80	4820324010	Feder	spring	1

81	4820325010	Federkappe	spring cap	1
82	0103005055	Schraube	inner hexagon screw	1
83	5020402010	Motorriemenscheibe	engine pulley	1
84	0105006006	Schraube	lock screw	1
85	4820402011	Schild	low belt shield	1
86	5310401010	Keil	key	2
87	5330402010	Messerhalter	bade adapter	1
88	5310402010	Reibscheibe	friction disk	2
89	4820403010	Messerhalter	blade	1
90	5310404010	Ring	lock ring	1
91	5310406010	Federscheibe#	spring washer	1
92	5310415010	Schraube	central screw	1
93	4820501010	Hebel	lever harness	2
94	4820502010	Hebel	lever weldment for engine barke	1
95	4820505010	Hebelabdeckung	lever cover	1
96	4820506010	Hebel Für Fahrkontrolle	lever weldment for drive control	1
97	4820511010	Drehpunkt Klammer	pivot bracket	1
98	4820510010	Hebel Abdeckung	lever cover	1
99	4820512010	Holm oben	upper handle	1
100	4820515010	Kabelbox Für Kontrollhebel	cable box for control levers	1
101	4820516010	Kabelbox Schild	cable box cover for control levers	1
102	0106004015	Schraube	cross slot screw	2
103	0106005040	Schraube	cross slot screw	2
104	4820520010	Rechtes Gehäuse f. Gasgriff	right cover of throttle box	1
105	4820520020	Schild	plug of throttle box	1
106	4820518020	Gashebel	bracket assembly of throttle box	1
107	4820519010	Linkes Gehäuse f. Gasgriff	left cover of throttle box	1
108	0108006050	Schraube	cross slot screw	1
109	4820513010	Stecker	plug for handle	2
110	0106004025	Schraube	cross slot screw	4
111	4820528010	Abdeckung	upper cover of drive control box	1
112	0108006030	Schraube	cross slot screw	2
113	0108006035	Schraube	cross slot screw	1
114	4820530010	Klammer	bracket assembly for drive control	1
115	4820529010	Abdeckung	bottom cover for drive control	1
116	4510511010	Startseilknopf	hook for start knob	1
117	4820536010	Griff	low handle	1
118	5310510010	Bolzen	bolt	2
119	4510510010	Scheibe	arc washer	2
120	5320517010	Kabelklammer	cable clamp	2
121	4820537010	Kupplungszug	cable for drive control	1

122	4820538021	Motorbremsdraht	cable for engine brake	1
123	4820539020	Gaszug	throttle cable	1
124	4820540010	Kabel	cable for tensional arm	1
P	4820601010		grass catcher assembly	1
125	4820603010	Rahmen	frame of garss catcher	1
126	4820611010	Fangsack	garss catcher	1
127	5320120010	Keilriemen	v belt	1
128	4820130010	Motorscheibe	engine washer	1
129	126T02	Motor	engine	1