

WB485SK AL V爆炸图 48SK050002B

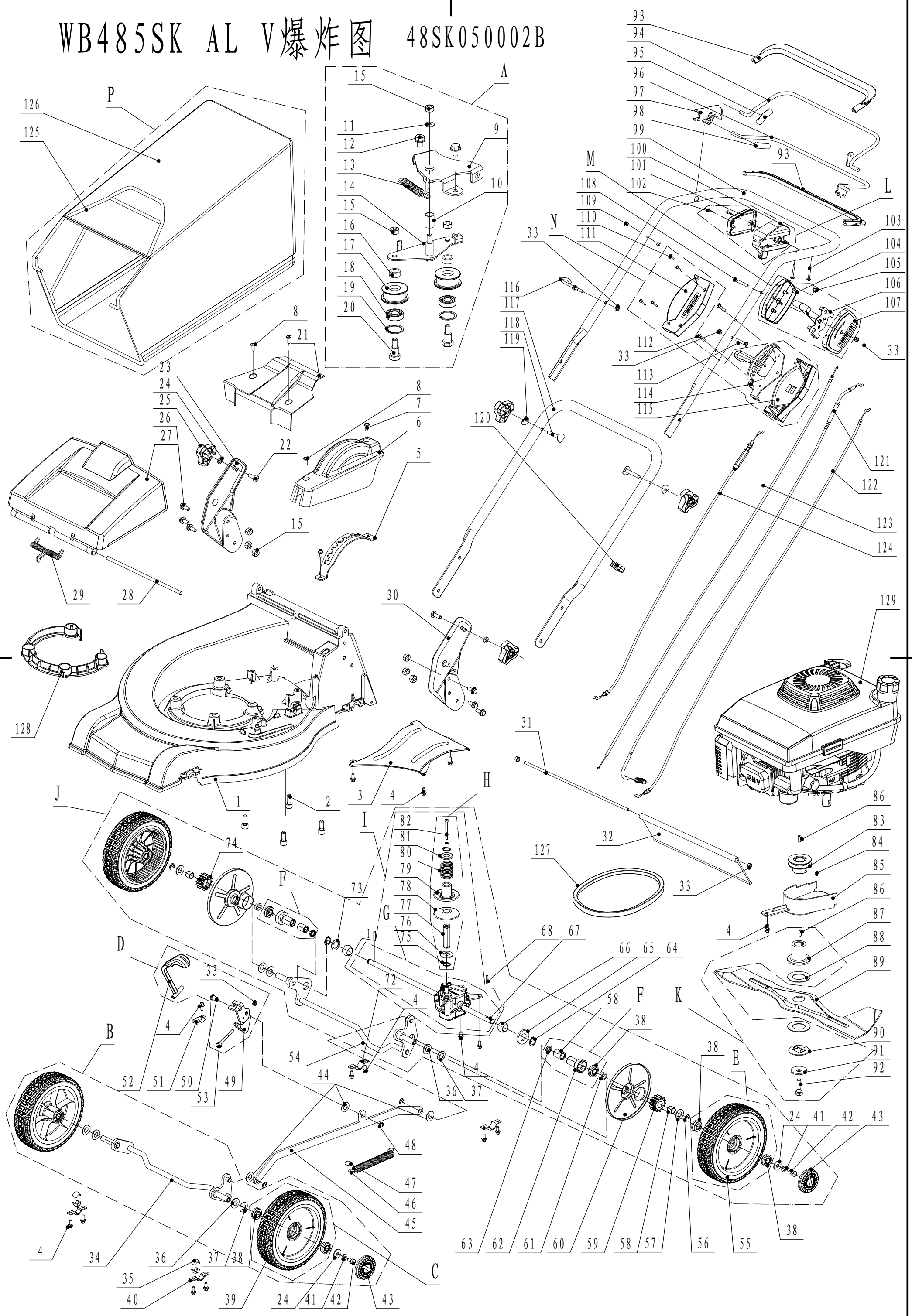

- 93
- 94
- 95
- 96
- 97
- 98
- 99
- 100
- 101
- 102
- 103
- 104
- 105
- 106
- 107
- 108
- 109
- 110
- 111
- 112
- 113
- 114
- 115
- 116
- 117
- 118
- 119
- 120
- 121
- 122
- 123
- 124
- 125
- 126
- 127
- 128
- 129
- 86
- 83
- 84
- 85
- 86
- 87
- 88
- 89
- 90
- 91
- 92
- 24
- 41
- 42
- 43
- 38
- 55
- 56
- 57
- 58
- 59
- 60
- 61
- 62
- 63
- 64
- 65
- 66
- 67
- 68
- 33
- 32
- 31
- 30
- 29
- 28
- 27
- 26
- 25
- 24
- 23
- 22
- 21
- 20
- 19
- 18
- 17
- 16
- 15
- 14
- 13
- 12
- 11
- 10
- 9
- 8
- 7
- 6
- 5
- 4
- 3
- 2
- 1
- 82
- 81
- 80
- 79
- 78
- 77
- 76
- 75
- 74
- 73
- 72
- 71
- 70
- 69
- 68
- 67
- 66
- 65
- 64
- 63
- 62
- 61
- 60
- 59
- 58
- 57
- 56
- 55
- 54
- 53
- 52
- 51
- 50
- 49
- 48
- 47
- 46
- 45
- 44
- 43
- 42
- 41
- 40
- 39
- 38
- 37
- 36
- 35
- 34
- 33
- 32
- 31
- 30
- 29
- 28
- 27
- 26
- 25
- 24
- 23
- 22
- 21
- 20
- 19
- 18
- 17
- 16
- 15
- 14
- 13
- 12
- 11
- 10
- 9
- 8
- 7
- 6
- 5
- 4
- 3
- 2
- 1

WB485SK AL V Ersatzteilliste

| Order | Teil Nummer | Bez.: Deutsch | Bez.: Englisch | Anzahl |
|-------|-------------|------------------|--------------------------------------|--------|
| 1 | 4820101001 | Gehäuse | mower chassis | 1 |
| 2 | 0103010025 | Schraube | inner hexagon screw | 4 |
| 3 | 4820103010 | Schutz | bottom deflector for discharge chute | 1 |
| 4 | 4820104010 | Schraube | hexagon flange lock screw | 16 |
| 5 | 4820105010 | Höhenverstellung | height adjustment graduator | 1 |
| 6 | 4820107010 | Schild | height adjustment shield | 1 |
| 7 | 4820106010 | Schraube | inner hexagon lock screw | 1 |
| 8 | 4820122010 | Schraube | inner hexagon lock screw | 3 |
| 9 | 4820109010 | Armklammer | tensional arm bracket weldment | 1 |
| 10 | 4820112010 | Nylon Klammer | nylon bush for tensional arm bracket | 1 |
| 11 | 0302008000 | Scheibe | big spacer | 1 |
| 12 | 4820113010 | Bolzen | hexagon flange lock bolt | 2 |
| 13 | 4820114010 | Feder | spring for tensional arm | 1 |
| 14 | 4820115010 | Spannarm | tensional arm weldment | 1 |
| 15 | 0202008000 | Mutter | hexagon flange lock nut | 9 |
| 16 | 4820118010 | Buchse | bush for tensional pully | 2 |
| 17 | 4820119010 | Spannrad | tensional pully | 2 |
| 18 | 6001-2RZ | Lager | bearing | 2 |
| 19 | 0901028000 | Ring | inner check ring | 2 |
| 20 | 4820120010 | Spannbolzen | tensional pully bolt | 2 |
| 21 | 4820121010 | Schild | upper belt shield | 1 |
| 22 | 4510513010 | Bolzen | square neck bolt | 2 |
| 23 | 4820125010 | rechter Halter | right bracket assembly | 1 |
| 24 | 0301008000 | Scheibe | flat washer | 6 |
| 25 | 4820541010 | Knopf | knob | 4 |
| 26 | 0102008016 | Bolzen | hexagon flange bolt | 6 |
| 27 | 4820126010 | Abdeckung | rear cover | 1 |
| 28 | 4820127010 | Stange | rear cover pivot | 1 |
| 29 | 4820128010 | Feder | rear cover torsional spring | 1 |
| 30 | 4820123010 | linker Halter | left bracket assembly | 1 |
| 31 | 5020117010 | Stange | rear axis | 1 |
| 32 | 4510111030 | Schutz | rear deflector | 1 |
| 33 | 0202006000 | Mutter | hexagon lock nut | 5 |
| 34 | 4820201010 | Frontachse | front bearing bracket | 1 |
| 35 | 5310209010 | Lager | bearing | 4 |
| 36 | 5310210010 | Scheibe | spacer | 4 |
| 37 | 5310211010 | Feder | equalizing spring | 4 |
| 38 | 5310213010 | Lager | WB bearing | 10 |
| 39 | 4820209010 | Vorderrad 8" | 8" front wheel | 2 |

| | | | | |
|----|------------|-------------------------|-----------------------------------|---|
| 40 | 4820208010 | Lagerhalterung | front bearing bracket | 2 |
| 41 | 0401008000 | Federscheibe | standard spring washer | 4 |
| 42 | 0101008015 | Bolzen | hexagon bolt | 4 |
| 43 | 4520205010 | Radschild | wheel hub cover | 4 |
| 44 | 4820306013 | Nylonscheibe | nylon washer | 3 |
| 45 | 4820306010 | Stange | draw staff weldment | 1 |
| 46 | 4820307010 | Feder | draw staff spring | 1 |
| 47 | 4820307011 | Sicherungskappe | D type check cap | 1 |
| 48 | 1301008000 | Sicherungsring | check ring | 3 |
| 49 | 4820310010 | Höhenverstellarm | height adjustment arm weldment | 1 |
| 50 | 4820309010 | Stift | draw staff pin | 1 |
| 51 | 4820308010 | Klammer für Höhenverst. | height adjustment arm clamp | 1 |
| 52 | 4820313010 | Höhenverstellgriff | height adjustment handle assembly | 1 |
| 53 | 0101006065 | Bolzen | bolt | 1 |
| 54 | 4820301010 | Hinterachse | rear axis weldment | 1 |
| 55 | 4820305010 | Antriebsrad | 8"propelled wheel | 2 |
| 56 | 1301009000 | Sicherungsring | check ring | 2 |
| 57 | 5020311010 | Reibscheibe | friction spacer | 2 |
| 58 | 5320326010 | Lager | bearing | 4 |
| 59 | 5320320010 | Zahnrad links | left output gear | 1 |
| 60 | 4520308010 | Radabdeckung | rear wheel dustproof cover | 2 |
| 61 | 4820318010 | Buchse | main axis bush | 2 |
| 62 | 5320324020 | Lager | left bearing bush | 2 |
| 63 | 5320327010 | Staubabdeckung | dustproof ring | 2 |
| 64 | 1001020000 | Sicherungsring | A type check ring for shaft | 2 |
| 65 | 4820326010 | Scheibe | left spacer of bearing bracket | 1 |
| 66 | 5320328010 | NylonLager | nylon bearing | 2 |
| 67 | 4820315011 | Getriebe | gearbox | 1 |
| 68 | 5320322010 | Stift | slide pin | 2 |
| 69 | 4820319010 | Getriebeanschlag | gearbox bracket | 1 |
| 72 | 5320114020 | Lagerhalterung | bearing braket | 2 |
| 73 | 4820327010 | Scheibe | right spacer of bearing bracket | 1 |
| 74 | 5320321010 | Zahnrad rechts | right output pinion | 1 |
| 75 | 1001017000 | Sicherungsring | outside check ring | 2 |
| 76 | 4820320010 | Scheibe | inner hexagon spacer | 1 |
| 77 | 4820321010 | Adapter | inner hexagon adapter | 1 |
| 78 | 4820322010 | Radscheibe | low disk of pulley | 1 |
| 79 | 4820323010 | Radscheibe | active disk of pulley | 1 |
| 80 | 4820324010 | Feder | spring | 1 |
| 81 | 4820325010 | Federkappe | spring cap | 1 |
| 82 | 0103005055 | Schraube | inner hexagon screw | 1 |
| 83 | 4820401010 | Motorriemenscheibe | engine pulley | 1 |

| | | | | |
|-----|------------|-----------------------------|------------------------------------|---|
| 84 | 0105006006 | Schraube | lock screw | 1 |
| 85 | 4820402010 | Schild | low belt shield | 1 |
| 86 | 4510401010 | Keil | key | 2 |
| 87 | 4510402010 | Messerhalter | bade adapter | 1 |
| 88 | 5310402010 | Reibscheibe | friction disk | 2 |
| 89 | 4820403010 | Messerhalter | blade | 1 |
| 90 | 5310404010 | Ring | lock ring | 1 |
| 91 | 5310406010 | Federscheibe# | spring washer | 1 |
| 92 | 5310415010 | Schraube | central screw | 1 |
| 93 | 4820501010 | Hebel | lever harness | 2 |
| 94 | 4820502010 | Hebel | lever weldment for engine barke | 1 |
| 95 | 4820505010 | Hebelabdeckung | lever cover | 1 |
| 96 | 4820506010 | Hebel Für Fahrkontrolle | lever weldment for drive control | 1 |
| 97 | 4820511010 | Drehpunkt Klammer | pivot bracket | 1 |
| 98 | 4820510010 | Hebel Abdeckung | lever cover | 1 |
| 99 | 4820512010 | Holm oben | upper handle | 1 |
| 100 | 4820515010 | Kabelbox Für Kontrollhebel | cable box for control levers | 1 |
| 101 | 4820516010 | Kabelbox Schild | cable box cover for control levers | 1 |
| 102 | 0106004015 | Schraube | cross slot screw | 2 |
| 103 | 0106005040 | Schraube | cross slot screw | 2 |
| 104 | 4820520010 | Rechtes Gehäuse f. Gasgriff | right cover of throttle box | 1 |
| 105 | 4820520020 | Schild | plug of throttle box | 1 |
| 106 | 4820518020 | Gashebel | bracket assembly of throttle box | 1 |
| 107 | 4820519010 | Linkes Gehäuse f. Gasgriff | left cover of throttle box | 1 |
| 108 | 0108006050 | Schraube | cross slot screw | 1 |
| 109 | 4820513010 | Stecker | plug for handle | 2 |
| 110 | 0106004025 | Schraube | cross slot screw | 4 |
| 111 | 4820528010 | Abdeckung | upper cover of drive control box | 1 |
| 112 | 0108006030 | Schraube | cross slot screw | 2 |
| 113 | 0108006035 | Schraube | cross slot screw | 1 |
| 114 | 4820530010 | Klammer | bracket assembly for drive control | 1 |
| 115 | 4820529010 | Abdeckung | bottom cover for drive control | 1 |
| 116 | 4510511010 | Startseilknopf | hook for start knob | 1 |
| 117 | 4820536010 | Griff | low handle | 1 |
| 118 | 5310510010 | Bolzen | bolt | 2 |
| 119 | 4510510010 | Scheibe | arc washer | 2 |
| 120 | 5320517010 | Kabelklammer | cable clamp | 1 |
| 121 | 4820537010 | Kupplungszug | cable for drive control | 1 |
| 122 | 4820538010 | Motorbremsdraht | cable for engine brake | 1 |
| 123 | 4820539010 | Gaszug | throttle cable | 1 |
| 124 | 4820540010 | Kabel | cable for tensional arm | 1 |
| 125 | 4820603010 | Rahmen | frame of garss catcher | 1 |

| | | | | |
|-----|------------|--------------|---------------|---|
| 126 | 4820611010 | Fangsack | garss catcher | 1 |
| 127 | 5320120010 | Keilriemen | v belt | 1 |
| 128 | 4820130010 | Motorscheibe | engine washer | 1 |
| 129 | FJ151V | Motor | engine | 1 |