

WB485SK AL爆炸图 48SK050001B

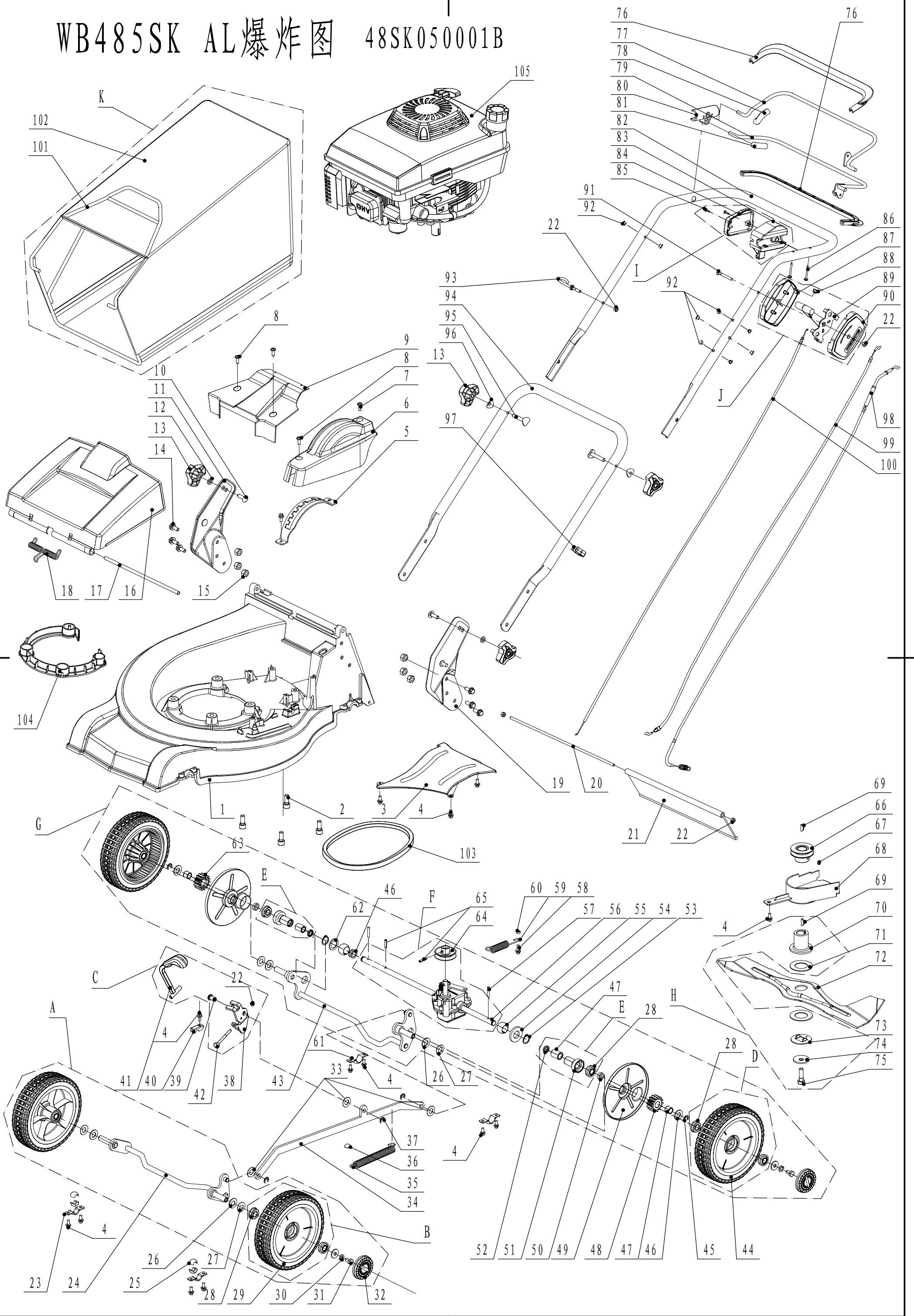

WB485SK AL Ersatzteilliste

Order	Teil Nummer	Bez.: Deutsch	Bez.: Englisch	Anzahl
1	4820101001	Gehäuse	mower chassis	1
2	0103010025	Schraube	inner hexagon screw	4
3	4820103010	Schutz	bottom deflector for discharge chute	1
4	4820104010	Schraube	hexagon flange lock screw	14
5	4820105010	Höhenverstellung	height adjustment graduator	1
6	4820107010	Schild	height adjustment shield	1
7	4820106010	Schraube	inner hexagon lock screw	1
8	4820122010	Schraube	inner hexagon lock screw	3
9	4820121010	Schild	upper belt shield	1
10	4510513010	Bolzen	square neck bolt	2
11	4820125010	rechter Halter	right bracket assembly	1
12	0301008000	Scheibe	flat washer	6
13	4820541010	Knopf	knob	4
14	0102008016	Bolzen	hexagon flange bolt	6
15	0202008000	Mutter	hexagon flange lock nut	6
16	4820126010	Abdeckung	rear cover	1
17	4820127010	Stange	rear cover pivot	1
18	4820128010	Feder	rear cover torsional spring	1
19	4820123010	linker Halter	left bracket assembly	1
20	5020117010	Stange	rear axis	1
21	4510111030	Deflektor	rear deflector	1
22	0202006000	Mutter	hexagon lock nut	5
23	4820208010	Lagerhalter	front bearing bracket	2
24	4820201010	Frontachse	front axle welding	1
25	5310209010	Lagerhalter	bearing	4
26	5310210010	Scheibe	spacer	4
27	5310211010	Feder	equalizing spring	4
28	5310213010	Lager	bearing	10
29	4820209010	Vorderrad	front wheel	2
30	0401008000	Federscheibe	spring washer	4
31	0101008015	Bolzen	bolt	4
32	4520205010	Radschild	wheel cover	4
33	4820306013	Nylponscheibe	nylon washer	3
34	4820306010	Stange	draw staff	1
35	4820307010	Feder	draw staff spring	1
36	4820307011	Kappe	D type check cap	1
37	1301008000	Sicherungsring	check ring	3
38	4820310010	Höhenverstellung	height adjustment arm weldment	1
39	4820309010	Stift	draw staff pin	1
40	4820308010	Höhenverstellarm	height adjustment arm clamp	1

41	4820313010	Griff	height adjustment handle assembly	1
42	0101006065	Bolzen	bolt	1
43	4820301010	Hinterachse	rear axis weldment	1
44	4820305010	Rad 8"	8"propelled wheel	2
45	1301009000	Sicherungsring	check ring	2
46	5020311010	Reibscheibe	friction spacer	2
47	5320326010	Lager	bearing	4
48	5320320010	Zahnrad links	left output gear	1
49	4520308010	Radabdeckung	rear wheel dustproof cover	2
50	4820318010	Buchse	main axis bush	2
51	5320324020	Lagerung	left bearing bush	2
52	5320327010	Staubabdeckung	dustproof ring	2
53	1001020000	Sicherungsring	A type check ring for shaft	2
54	4820326010	Platzhalter für Lagerklammer	left spacer of bearing bracket	1
55	5320328010	Nylon Lager	nylon bearing	2
56	4820315010	Getriebe	gearbox	1
57	5320322010	Stift	slide pin	2
58	4820104011	Schraube	hexagon lock screw	1
59	4820317010	Feder	spring of gearbox	1
60	4820317011	Scheibe	spacer	1
61	5320114020	Klammer	bearing braket	2
62	4820327010	Platzhalter für Lagerklammer	right spacer of bearing bracket	1
63	5320321010	Zahnrad rechts	right output pinion	1
64	5020308020	Riemenscheibe/Getriebe	gearbox pulley	1
65	0701005020	Feder	spring pin	2
66	4820401020	Motorriemenscheibe	engine pulley	1
67	0105006006	Schraube	lock screw	1
68	4820402010	Schild	low belt shield	1
69	4510401010	Keil	key	2
70	4510402010	Messerhalter	bade adapter	1
71	5310402010	Reibscheibe	friction disk	2
72	4820403010	Messer	blade	1
73	5310404010	Ring	lock ring	1
74	5310406010	Federscheibe	spring washer	1
75	5310415010	Schraube	central screw	1
76	4820501010	Hebel	lever harness	2
77	4820502010	Hebel	lever weldment for engine barke	1
78	4820505010	Hebel Abeckung	lever cover	1
79	4820506010	Hebel f. Fahrkontrolle	lever weldment for drive control	1
80	4820511010	Drehpunktklammer	pivot bracket	1
81	4820510010	Hebel Abeckung	lever cover	1
82	4820512020	Holm oben	upper handle	1

83	4820515010	Kabelbox Für Kontrollhebel	cable box for control levers	1
84	4820516010	Schild f. Kabelbox	cable box cover for control levers	1
85	0106004015	Schraube	cross slot screw	2
86	0106005040	Schraube	cross slot screw	2
87	4820520010	Rechtes Gehäuse f. Gasgriff	right cover of throttle box	1
88	4820520020	Schild	plug of throttle box	1
89	4820518020	Gashebel	bracket assembly of throttle box	1
90	4820519010	Linkes Gehäuse f. Gasgriff	left cover of throttle box	1
91	0108006050	Schraube	cross slot screw	1
92	4820513010	Stecker	plug for handle	8
93	4510511010	Startseilknopf	hook for start knob	1
94	4820536010	Holm unten	low handle	1
95	5310510010	Bolzen	bolt	2
96	4510510010	Scheibe	arc washer	2
97	5320517010	Kabelklemme	cable clamp	1
98	4820537010	Kupplungsseil	cable for drive control	1
99	4820538010	Motorbremsdraht	cable for engine brake	1
100	4820539010	Gaszug	throttle cable	1
101	4820603010	Rahmen	frame of garss catcher	1
102	4820611010	Fangsack	garss catcher	1
103	5320120010	Keilriemen	v belt	1
104	4820130010	Mortorscheibe	engine washer	1
105	FJ151V	Motor	engine	1